

**DIYA-R**  
BOLLARD

divinitylights





## DIYA-R BOLLARD

Diya-R Bollard fixture has :

- Luminaire housing of Aluminium
- IP66, High Ingress Protection against dust & moisture
- Flicker free operation for eye protection
- Energy-efficient LED with high colour rendering
- The built quality ensures long and maintenance free service life
- Optimum for every outdoor space including society parks, streets, educational institutes, and pathways
- Garden & pathway luminaires create pleasant light distribution with a high degree of visual comfort
- LED bollard, designed to provide radially symmetric light emission of 360°
- Sustainable LED technology offers durability and optimal light output with low power consumption

### Quick Info

CRI  $\geq 90$

2700K, 3000K, 4000K

Non-Dimmable/ Dali-Dimmable

SDCM <3

Frosted Glass Diffuser

L70 @50,000h

Aluminium Die-Cast

### Types

Surface

### Single Line Diagram

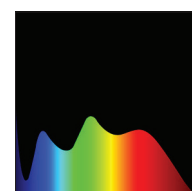
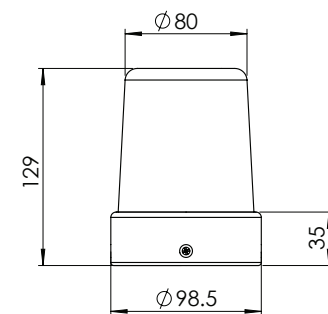

CRI  $\geq 90$

DIYA-R BOLLARD



Product Order Code	System Power	Dimensions
1880	5W	Dia=80mm H=129mm

Order Options

CCT (Colour Temperature)

- 2700K
- 3000K
- 4000K

CRI

- >90

Beam Angle

- N.A

Control

- Non-Dimmable 
- Dali-Dimmable 

Mounting Type

- Surface

Material Colour

- Grey 